

EZee Life™

Single Motor Lift Chair User Manual



(CH4015 Pictured)

EZee Life™ Products
34 Futurity Gate, Unit 15, Concord, ON L4K 1S6



INTRODUCTION:

This Lift and Massage chair is designed to help people rise easily from the chair using electrically operated motors and to relax both body and mind with the built-in massage system.

Please read the operation manual thoroughly for the correct usage of the chair, especially the notes on safety.

Please keep this manual available for future reference after you have read it through.

CONTENTS:

Safety Information	2
Specifications	4
Assembly Instructions	5
Chair Placement	6
Product Care and Storage	7
Battery Back Up System	7
Remote Position Controller	8
Remote Heat/Massage Controller	9
Warranty Information	9

Safety Information

- Warning - The chair must be assembled correctly according to the assembly instruction enclosed. The manufacturers of the chair, their agents and distributors are not liable for any damages caused by improper assembly of the chair.
- The chair must be placed on a flat, level floor.
- Do not use your chair in an excessively humid or dusty environment, as it may cause electrical shock or mechanical problems. The chair must be in a dry room.
- Do not use your chair in room temperatures higher than 40 degrees.
- Do not expose your chair to heaters, stoves or direct sunlight to protect the upholstery.

Safety Information Continued

- Do not use the chair outdoors.
- When the chair is not in use for long periods of time, disconnect the power cord from the main supply to avoid overheating.
- Do not rest or place any heavy object on the armrest, footrest or back of the chair.
- Do not jump or play on the chair.
- Children must be supervised by an adult when using the lift chair. This chair is not intended for children.
- Check that the voltage corresponds with the specifications indicated for the chair.
- Electrical connection must be made in accordance with local regulation.
- Do not disconnect the plug from the electrical outlet roughly or unplug by pulling on the cord.
- Do not connect or disconnect the plug from the electrical outlet with wet hands. It may result in electrical shock or mechanical breakdown.
- Do not place the AC/DC adaptor cord under the Chair as it may damage the cord and result in fire or electrical shock.
- Do not let the AC/DC cord hang down from the chair.
- Do not use the Chair if the AC/DC cord or plug is damaged, or if the electrical outlet is excessively loose. Contact a professional for inspection.
- If necessary, the power cable may be replaced with an identical one, but it must only be replaced by a qualified technician.
- Do not touch the surface of the plug immediately after use, as it can be hot.
- Do not operate the remote control with wet hands, sharp or heavy objects.
- Avoid dropping the remote control.
- Do not step or place heavy objects on the remote control wire.





- Do not put your fingers and hands in between the seat and the footrest when the chair is reclining or when the chair is returning back from the recline position to sitting position. You may hurt your fingers/hands badly.
- This Chair must be used in accordance with the instruction provided.
- This Chair is not for professional use.
- The manufacturers of this chair, their agents and distributors are not liable for any damages to person(s) or property(s) resulting from improper use of the chair.
- Use caution when using the lift feature if the chair back is reclined. The back should be in the upright position when entering and leaving the chair unless a side transfer is being done using vertical lift.
- Ensure the chair casters are braked when transferring.

Caution: A sudden change in temperature from cold to warm can cause condensation on electrical and mechanical parts. It is recommended that the chair be allowed to warm up for a minimum of an hour before using to ensure proper operation and reduce the chances of mechanical breakdown.

Do not use the lift chair if any of the following events occur:

- Water is accidentally spilled on the chair. This may result in electrical shock.
- The upholstery is torn and the inside mechanism is exposed.
- You detect any malfunction or another abnormal condition during operation.

Use Caution if there is a power failure. Injury may occur when power is restored unexpectedly if the operation buttons are depressed.

Avoid using the chair during severe lightning storms.

Please switch the power OFF immediately and disconnect the AC power cord from the electrical outlet in the event of accidental damage or malfunction.

Contact a professional for servicing.

Specifications:

Weight - The weight of the chair is 60 kgs (132 lb)

- The maximum weight capacity of the chair is 160 kgs (352 lb)

Power Requirements - 100~240 V 50 Hz 70 W

Note motor operation: 2 minutes is available for continual use, allow 15 to 30 seconds between cycling the motor.

Casters:

Your lift chair is supplied with four casters for easy movement of chair and transferring of the user. Ensure the rear casters are locked before using any of the positioning functions to prevent movement and possible injury or damage.

Assembly:

Some models of chairs are packaged in two pieces consisting of the back and the base to make transport and delivery easier. Assemble the chair as per the assembly Instructions below.



Directions:

- 1) Remove seat and back from packing bags.
- 2) Hold back and upholstery flap with both hands and line up brackets.
- 3) Apply downward pressure and ensure both sides snap into locked position.

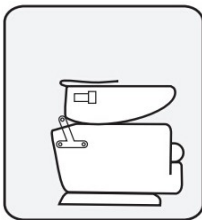

STEP 1

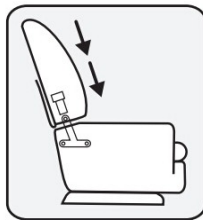

STEP 2

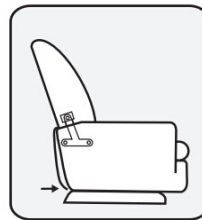

STEP 3

Note: Both back receivers need to be lowered onto the to flat bars at the same time and evenly to prevent binding.

Note: Do not assemble the chair if the upholstery or any of the parts of the chairs are damaged.

Check all parts carefully before assembling the chair. If any problem is apparent contact the vendor.

Electrical Connections:

Note: Make sure all the wires are properly connected to ensure proper function.

- (1). Connector for the motor and wiring
- (2). Connector for wiring and adaptor
- (3). Connector for adaptor wiring and plug wiring
- (4) Hand control connection

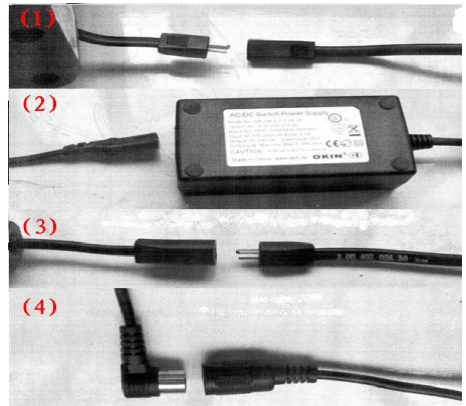

Chair Placement:

- Allow sufficient space in front of and behind the chair for reclining purpose.
- To allow for unimpeded reclining make sure there is a minimum of 65 cm behind the chair.
- Ensure there is at least 40cm in front of the chair.
- Place the chair on a flat surface/floor in a dry room.



Caution:

Make sure there is no obstruction behind or in front of the chair for a safe recline and lift during operation.

The area between the seat and the footrest should be kept clear to avoid pinching hazard while the chair is operating.

Product Care & Storage :**1. How to store**

- Wipe the dust and dirt off. Keep the chair clean and away from places of high humidity
- If the chair is not in use for a long period of time, cover it with a piece of clean cloth to protect it from dust. Store in a dry room.
- Do not store the chair under direct sunlight or in places of high temperatures. This may result in the fading of fabric colour.

2. Self-maintenance

- Before cleaning, ensure that the Main Switch is turned off and AC plug is removed for the electrical outlet.
- Do Not use wet towels to clean chairs with leatherette upholstery (PU) unless it is our incontinent leatherette. Leather cleaning agents are allowed.

3. Main Body

- Very mild soap can be used to clean the plastic, pipe and upholstery of the Chair. Carefully wipe away all traces of the soap with dry cloth.
- To clean a dry spot, dip a piece of soft cloth into some warm soap water, wring the cloth dry, and apply it to the spot.
- Do not use cleaning agents like benzene or thinner, or any other cleaners which may result in fading of fabric color and scratching of upholstery.
- Do not remove the upholstery for washing. Ironing of upholstery is strictly prohibited





Battery Back Up System:

These chairs are supplied with a battery back up system to allow exiting the chair during a power failure.

Two 9 volt batteries are required and not supplied with the chair.

In the event of a power failure the chair will automatically switch over to battery power but only run for one cycle before the batteries are discharged. It is recommended that the batteries are replaced after each emergency use.

Remote Position Controller Unit:

- Use only dry cloth for cleaning of the unit. Excess moisture may damage the controller.

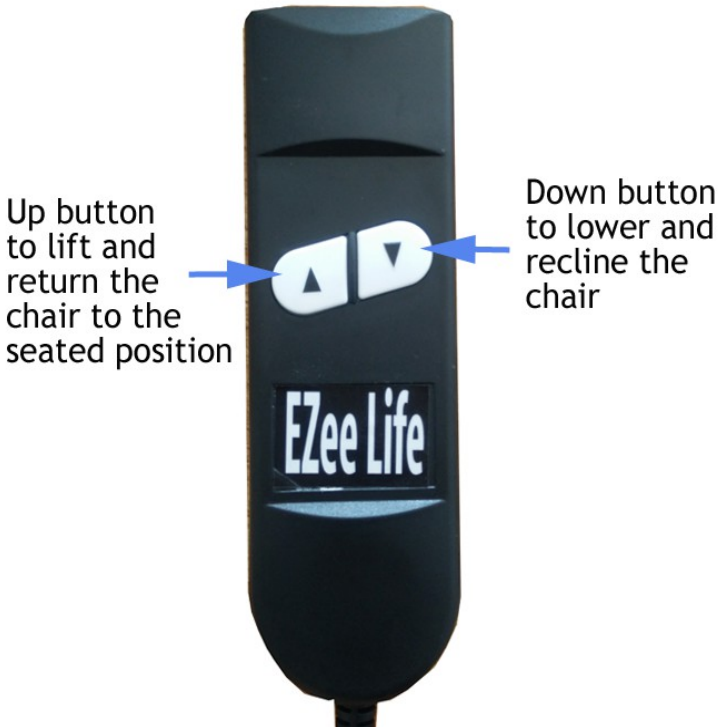

Remote Massage Controller (for chairs equipped with massage):

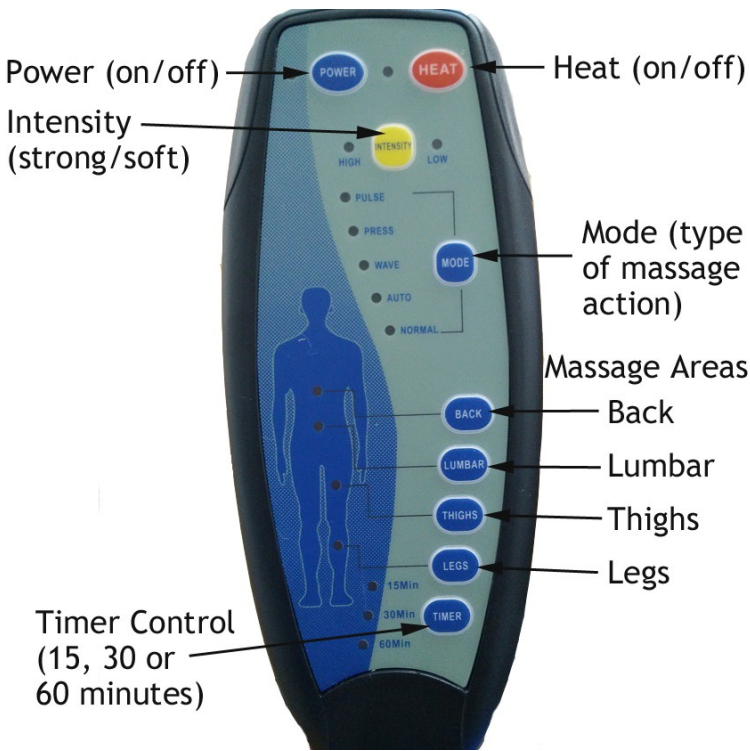

Cautions:

- If the chair doesn't work properly, please contact the supplier.
- Only trained technicians should attempt repairs.
- There are no user serviceable parts inside.

Limited Warranty Information

EZee Life™, through its authorized distributor/service organization, warrants our Planet lift chair line to the original consumer only, be free from material workmanship problems as follows:

1. Lifetime warranty on all Planet lift chair steel lift mechanism.
2. First year warranty on parts and labour.
3. Second and third years parts only warranty.

Warranty Exemptions:

- Any alterations, misuse, or abuse
- Exceeding the weight capacity (352 lb / 160 kg)
- Accidental damage
- Commercial use
- Battery leakage or spillage damage
- Abnormal use damage
- Improper storage or contamination damage
- Upholstery damage, other than manufacturing defect.

EZee Life™, at it's sole discretion, reserves the right to replace or repair any part that has become defective.

The warranty does not extend to consequential costs resulting from the fault or defect of the product: freight and travel costs, loss of earnings, or other expenses that one may incur.

Warranty is valid for the original purchaser only and the original receipt must be presented before any warranty options are considered. Please also be prepared to provide the date of purchase and serial number.

Implied Warranties:

Implied warranties, including those of merchantability and fitness for a particular purpose, are limited to one (1) year from the date of purchase and to the extent permitted by law. Any and all implied warranties are excluded. This is the exclusive remedy. Liabilities for consequential damages under any and all warranties are excluded.

Date of Purchase: _____

Dealer Name: _____

Dealer Location: _____

Chair Serial Number: _____